

Safety-Multifly®-BloodCulture Set

Instructions for Use

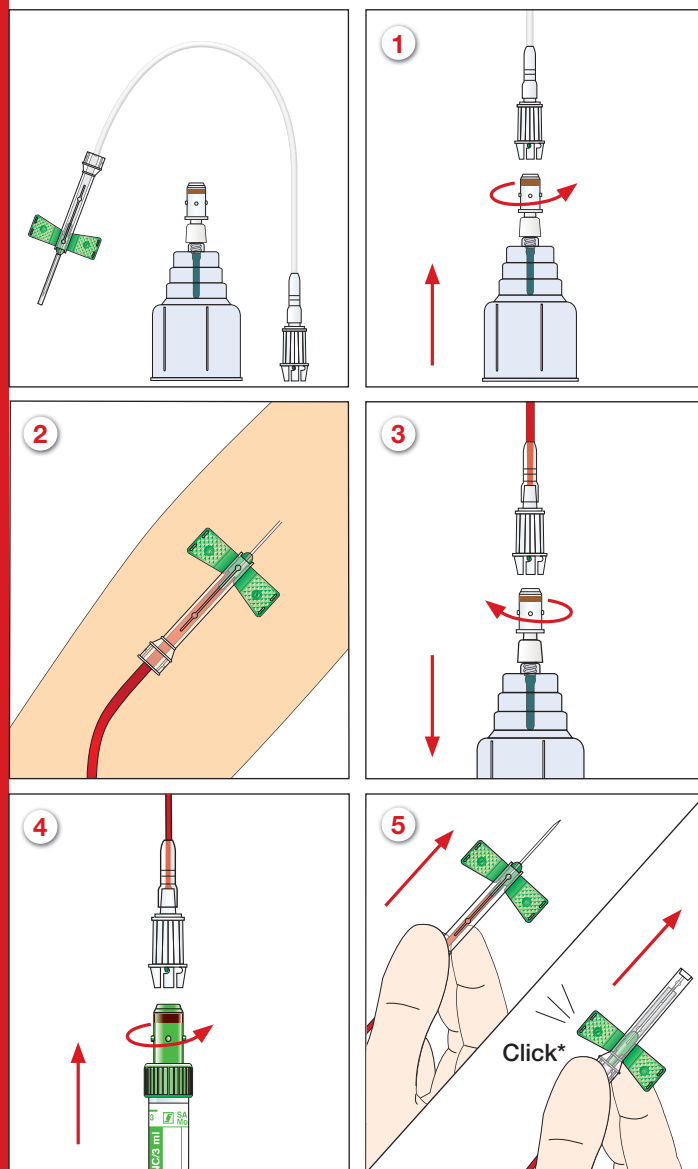

Open the set to remove the individually wrapped products. Prepare the puncturing site for blood collection in accordance with your institutional guidelines and regulations. Tear open the packaging of the Universal-BloodCulture-Adapter (Order No. 14.1209) and of the Safety-Multifly®-Needle with due regard to aseptic methods.

- 1) Assemble the Universal-BloodCulture-Adapter with the guide sleeve of the Safety-Multifly®-Needle.
- 2) Wait before removing the protective cover of the Safety-Multifly®-Needle until immediately prior to use. Puncture the vein **with the needle bevel facing upward**. Perform blood collection with the Blood Culture bottle.
- 3) For further blood collections using the S-Monovette®, detach the Universal-BloodCulture-Adapter from the guide sleeve of the Safety-Multifly®-Needle.
- 4) You can now collect blood in accordance with the instructions for use on the S-Monovette® packaging and your institutional guidelines and regulations.
- 5) After blood collection:
Hold the needle protector at its back end with your thumb on top and your forefinger below. Withdraw the Safety-Multifly®-Needle from the vein by holding the tubing against the palm of your hand and push the needle protector over the needle until it is noticeably and visibly locked in the safety mechanism.

* Attention:

Without an audible "click", the safety mechanism is not activated and cannot provide protection. After activating the protective mechanism, discard the safely locked Safety-Multifly®-Needle in a disposal box. Make sure to keep your hands well behind the needle tip throughout the entire procedure. Do not attempt to manipulate or disengage the safety mechanism.

Short term infusion:

The Safety-Multifly®-Needle of this set is suited for short term infusion. Remove the blood collection adapter of the Safety-Multifly®-Needle and connect the Luer-Lock-Adapter of the infusion tubing to the free Luer-Adapter of the Safety-Multifly®-Needle. Prepare the Safety-Multifly®-Needle as described under 2) above. Ensure that the system including the Safety-Multifly®-Needle is filled bubble-free before venipuncture. Hold the Safety-Multifly®-Needle in place after venipuncture. Make sure to use the Safety-Multifly®-Needle for gravity infusion only.

Caution: Do not use needles from open or damaged packaging. Never draw blood with bent, damaged or previously used needles. Wear gloves.

Ordering Information

Order No.	Description	Packaging
51.1638.945	Safety-Multifly®-BC Set 21G including 1 ind. wrapped Safety-Multifly®-Needle 21G (200mm tubing) and 1 ind. wrapped Universal-BloodCulture-Adapter	50 pcs. / case
51.1640.945	Safety-Multifly®-BC Set 23G including 1 ind. wrapped Safety-Multifly®-Needle 23G (200mm tubing) and 1 ind. wrapped Universal-BloodCulture-Adapter	50 pcs. / case