

## ADULT MORTUARY SERVICE USER GUIDE

### ADDRESSES:

#### Adult Mortuary

Ground Floor  
Clinical Sciences Centre  
Manchester Royal Infirmary  
Oxford Road  
Manchester  
M13 9WL  
Tel 0161 276 4476  
Email: [adult.mortuary@mft.nhs.uk](mailto:adult.mortuary@mft.nhs.uk)

#### Wythenshawe Hospital Mortuary

Wythenshawe Hospital  
Southmoor Road  
Wythenshawe  
Manchester  
M23 9LT  
Telephone: Office 0161 291 2541  
Email: [Mortuary@mft.nhs.uk](mailto:Mortuary@mft.nhs.uk)

#### North Manchester Hospital Mortuary

North Manchester General Hospital  
Delaunays Rd,  
Crumpsall,  
Manchester  
M8 5RB  
Tel: 0161 7202255

#### Adult Mortuary

Trafford General Hospital  
Moorside Road  
Davyhulme  
Manchester  
M41 5SL  
Telephone: Office 0161 7462504  
Email: [adult.mortuary@mft.nhs.uk](mailto:adult.mortuary@mft.nhs.uk)

**MORTUARY OPENING HOURS**

The Mortuaries are staffed between the hours of 8:00am and 4:00pm, Monday to Friday. Outside of these hours, and over the weekend, there is an on-call technician available via Switchboard.

**Note:** Trafford mortuary is not fully staffed and is by appointment only, staffing provided by other sites.

We are open to Funeral Directors during the following times:

**Monday:** 10:00am – 15:30

**Tuesday:** 9:00am – 15:30

**Wednesday:** 9:00am – 15:30

**Thursday:** 9:00am – 15:30

**Friday:** 9:00am – 15:30

The family visiting suite is open to the general public via an appointment system during the following times.

**Monday-Friday:** 13:00pm – 15:45pm

We are closed in the afternoon from 2pm on the first Wednesday of every month for staff training.

**MORTUARY STAFF**

Mortuary Office telephone ext 64476, 0161 2912541 (Wyth), 0161 720 2255 (NMGH)  
 Management office ext 64972

John Hayes	Directorate Manager Cellular Pathology	<a href="mailto:john.hayes@mft.nhs.uk">john.hayes@mft.nhs.uk</a>
Sharon McMinn	Mortuaries Services Manager and Adult Bereavement Lead	sharon.mcminn@mft.nhs.uk
Emily Moore	Deputy Mortuary Services Manager	emily.moore3@mft.nhs.uk
Rachael Whittaker	Senior Adult Anatomical Pathology Technician	rachael.whittaker@mft.nhs.uk
Belinda Gerzina	Adult & Paediatric Anatomical Pathology Technician	belinda.gerzina@mft.nhs.uk

Division of Laboratory Medicine

Faye White	Adult & Paediatric Anatomical Pathology Technician	faye.white@mft.nhs.uk
Stephen Wright	Adult & Paediatric Anatomical Pathology Technician	stephen.wright@mft.nhs.uk
Dean Pratt	Trainee Anatomical Pathology Technician	dean.pratt@mft.nhs.uk
Kaiine Egan	Trainee Anatomical Pathology Technician	kaiine.egan@mft.nhs.uk
Caprice Morris	Trainee Anatomical Pathology Technician	caprice.morris@mft.nhs.uk
Suzanne Todd	Trainee Anatomical Pathology Technician	suzanne.todd@mft.nhs.uk
Tanya McGrane	Mortuary Support Worker	tanya.mcgrane@mft.nhs.uk
Jennifer Ng	Mortuary Support Worker	Jennifer.ng@mft.nhs.uk
Martin Hodnett	Mortuary Support Worker and Transport Driver	martin.hodnett@mft.nhs.uk
Samantha White	Mortuary Support Worker	Samantha.white@mft.nhs.uk
Samuel Lee	Mortuary Support Worker	Samuel.Lee@mft.nhs.uk

### MORTUARY LOCATION

The Adult Mortuary at Oxford road Campus is on the ground floor of the Clinical Sciences Centre. The entrance into the building is located on the boulevard next to Corbett House entrance. Once through the entrance, the mortuary is signed posted as “Mortuary Viewing Suite”.



The Mortuary at Wythenshawe is located off Southmoor road; across from the starlight children’s department (highlighted in green on the map).

See map below:

Division of Laboratory Medicine



North Manchester Mortuary is located at the end of A Block in the blue section as shown on the map below:



Trafford General Hospital mortuary is located in the Pathology Department, located on the map below:

## Division of Laboratory Medicine

### Directions to the FPBU from the Hospital main entrance

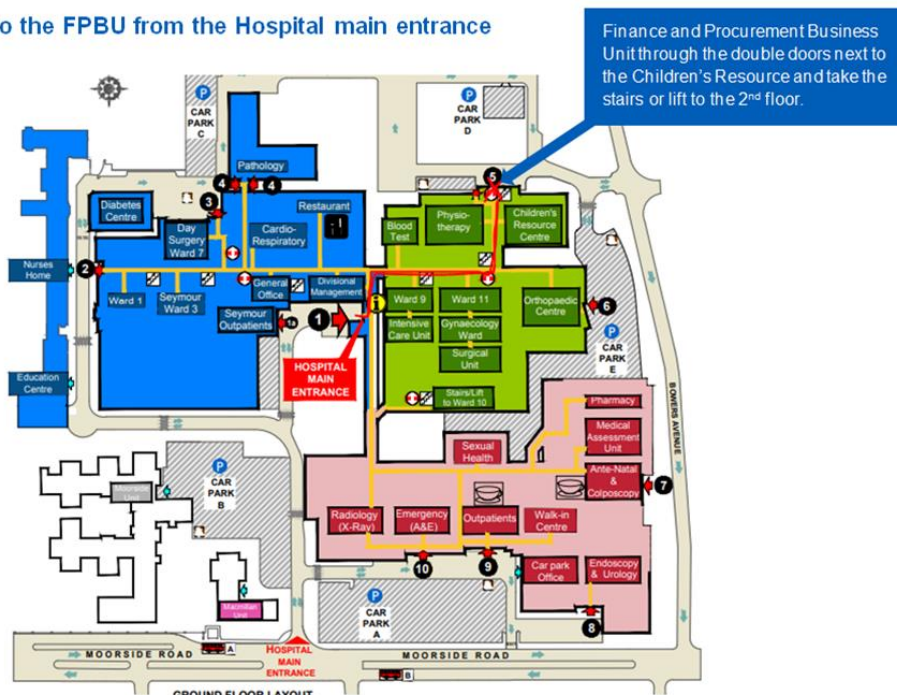

## **POST MORTEM EXAMINATIONS**

Post mortem examinations are carried out for the Manchester City Area Coroner. All Post Mortem examinations are performed at Oxford Road Campus site.

Hospital consented post mortem examinations may also be carried out. For a hospital consent post mortem to take place, the mortuary must have the patient hospital notes and written consent. The consent form must be fully completed; that the cooling off/change your mind period has been agreed with the consent-giver and documented and that the form has been signed.

## **VIEWING FACILITIES**

Viewings are carried out in accordance with hospital policy and are managed by mortuary staff. The family viewing suite operates on an appointment basis; relatives can ring the mortuary directly to book an available time.

Viewings can be facilitated out of hours via the on-call mortuary staff, these appointments are not guaranteed. The on-call staff member does not have access to the diary to make future appointments. Families who wish to do this to contact the mortuary the next working day.

## **POST MORTEM REPORTS**

The time taken to issue a report following a post mortem examination varies, depending on the complexity of the case and tests carried out. In coronial cases an initial cause of death, if established, will be given to the Coroner on the day of the post mortem examination. **Please note that any clinician / relative wanting a copy of this report must obtain it via the Coroner's office.**