

Trafford General Hospital

Ward & Department Guide

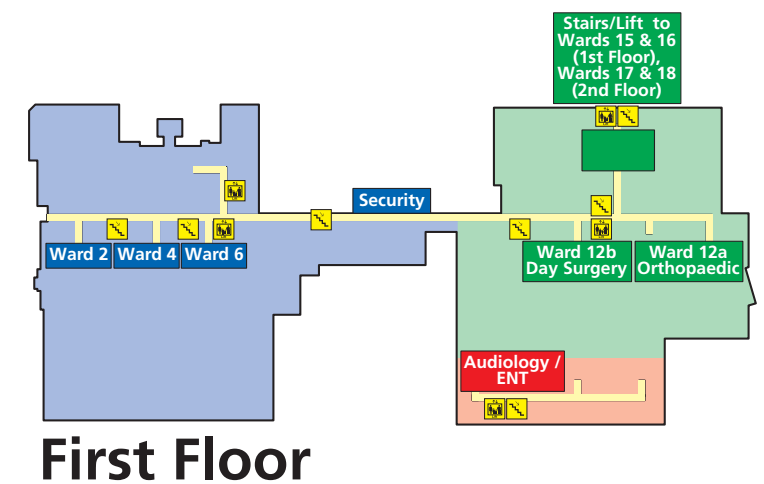
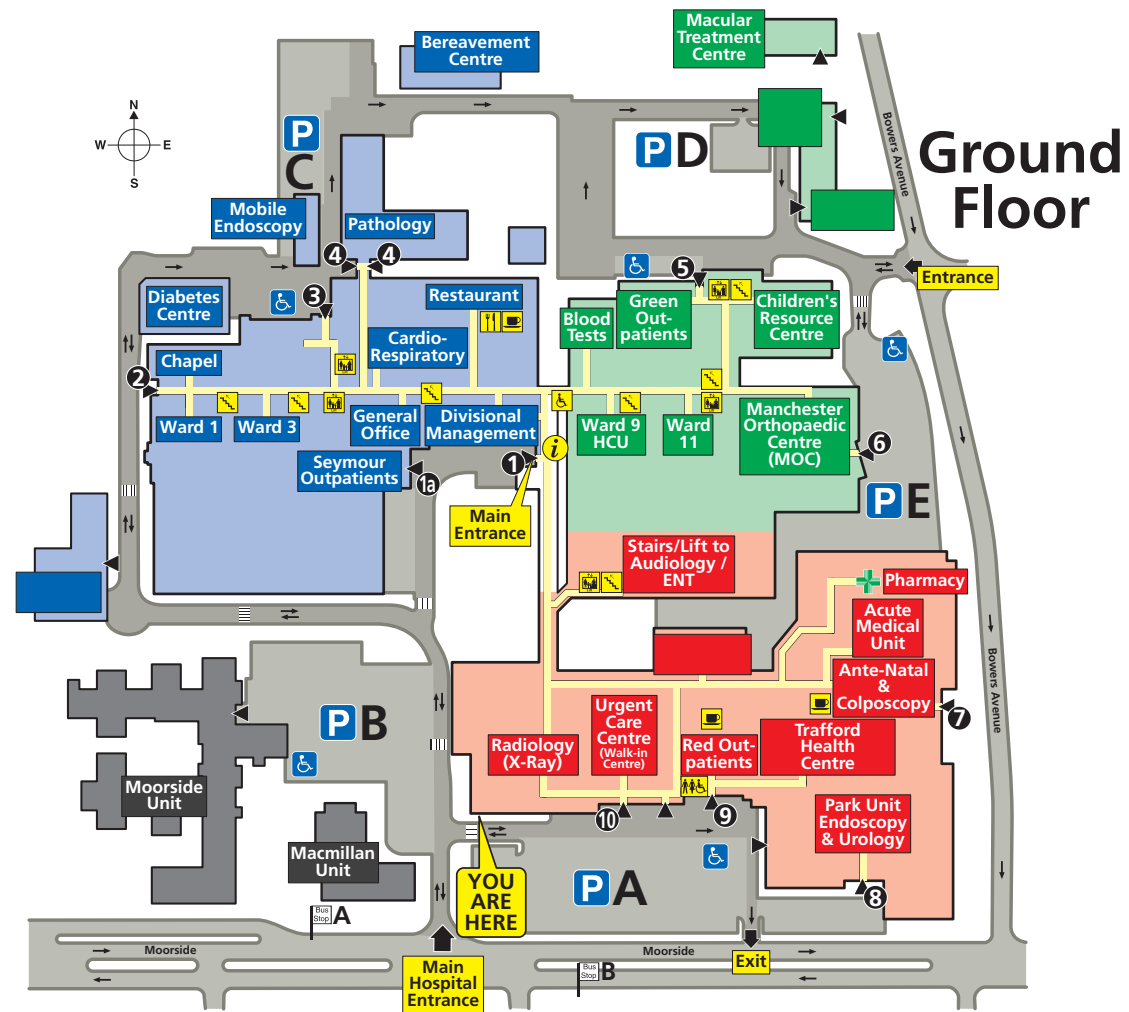

- Site entrance
- Car park
- Disabled parking
- Bus stop
- Building entrance
- Main reception
- Main corridors
- Lift
- Stairs
- Restaurant
- Tea bars

Department	Zone	Floor
Acute Medical Unit	Red	Grd
Ante-Natal Clinic	Red	Grd
Audiology	Red	1st
Bereavement Centre	Blue	Grd
Blood Tests (Phlebotomy)	Green	Grd
Boardrooms 1, 2 & 3	Blue	Grd
Cancer Services	Red	Grd
Cardio-Respiratory Unit	Blue	Grd
Chapel / Prayer Room	Blue	Grd
Children's Outpatients	Green	Grd
Children's Resource Centre	Green	Grd
Children's Resource Centre	Green	Grd
Children's Ward	Green	Grd
Colposcopy	Red	Grd
Day Surgery	Green	1st
Dental / Oral & Maxillofacial	Red	Grd
Diabetes Centre	Blue	Grd
Divisional Management	Blue	Grd
Ear, Nose & Throat (ENT)	Red	1st
Education Library	Green	1st
Endoscopy	Red	1st
Estates & Facilities	Blue	1st

Department	Zone	Floor
General Office	Blue	Grd
Gynaecology	Red	Grd
INRU	Blue	Grd
Macmillan Unit	External Access (see map)	
Macular Treatment Centre	External Access (see map)	
Manchester Orthopaedic Centre (MOC)	Green	Grd
Moorside Unit	External Access (see map)	
Mobile Endoscopy Unit	External Access (see map)	
Occupational Health	Pathology Laboratory	1st
Occupational Therapy	Green Outpatients	Grd
Oral & Maxillofacial / Dental	Red Outpatients	Grd
Orthopaedics	Ward 12a	1st
PALS	Red	Grd
Pathology Laboratory	Blue	Grd
Pharmacy	Red	Grd
Phlebotomy (Blood Tests)	Green	Grd
Physiotherapy	Green Outpatients	Grd
Pre-Operative Assessment	Manchester Orthopaedic Centre (MOC)	Grd
Radiology (X-Ray)	Red	Grd
Restaurant	Blue	Grd
Rheumatology	Ward 1	Grd

Department	Zone	Floor
Security	Blue	1st
Seymour Outpatients	Blue	Grd
Speech & Language Therapy	Green Outpatients	Grd
Stroke Unit	Ward 1	Grd
Suite 5	Manchester Orthopaedic Centre (MOC)	Grd
Tea Bar	Red	Grd
Trafford Health Centre	Red	Grd
Trafford High Care Unit	Ward 9	Grd
Ultrasound	Radiology (X-Ray)	Grd
Urgent Care Centre (Walk-in Centre)	Red	Grd
Urodynamics	Red	Grd
Urology	External Access - Park Unit	Red
Ward 1 (Stroke Unit)	Blue	Grd
Ward 2	Blue	1st
Ward 3 (INRU)	Blue	Grd
Ward 4	Blue	1st
Ward 6	Blue	1st
Ward 9 (Trafford High Care Unit)	Green	Grd
Ward 11	Green	Grd
Wards 12a (Orthopaedics) & 12b (Day Surgery)	Green	1st
Wards 15 & 16	Green	1st
Wards 17 & 18	Green	2nd
X-Ray (Radiology)	Red	Grd